

Portland Parks Foundation
 15 Years of Building Common Ground
 1500 SW 1st Avenue, Suite 760
 Portland, OR 97201

Annual Report 2016
 Portland Parks Foundation
 15 Years of Building Common Ground



Our Mission

The Portland Parks Foundation mobilizes financial and popular support to ensure a thriving and accessible parks system for a healthy Portland.

Dear Friends of Parks,

The *New York Times* recently reported on “The Difference a Park Makes.” Whether new city parks are earning headlines or simply making a difference in neglected neighborhoods, the Times reports that major American cities are “banking on parks and public spaces to drive social and economic progress.”

In Portland we feel as though we’ve always known what a difference a park makes. Forest Park marked Portland as a city that would always value wilderness at its doorstep. Waterfront Park reframed the city’s relationship to the Willamette River. And the new Thomas Cully Park, now in development through a unique collaboration of public and private resources, is essential to the Cully neighborhood’s vision of a community distinguished by a healthy environment, local job base, affordable housing, diverse people, and a culture of welcome and safety.

Portland Parks Foundation exists to help realize visions like these. As shared in this report, we worked throughout 2016 to raise funds for important new projects, connect people and support an active base of community volunteers. From high-profile projects like the Footbridge Over Burnside and Cully Park, to “best kept secrets” like North Portland’s Peninsula Park Rose Garden, PPF supported communities’ initiative and leadership in making a difference.

To further our capacity to help, we also inaugurated the Charles Jordan Circle to acknowledge our donors, involve them in our work, and honor the work of community volunteers; and we announced plans to develop a mini-grant program in 2017 for support of private groups’ efforts to enhance the stewardship provided by Portland Parks & Recreation for the city’s 11,500 acres of parks and natural areas.

We’re grateful to all who supported PPF’s work this past year. In 2017 we look forward to completing our current campaigns, increasing the legions of Portland park supporters, and to finding new and creative ways to serve the city’s people with the best parks imaginable. To paraphrase a quote from that Times article: we want every Portlander to be able to walk to a park that says, “You are worth it!”

We want every
 Portlander to be able to
 walk to a park that says,
 “You are worth it!”

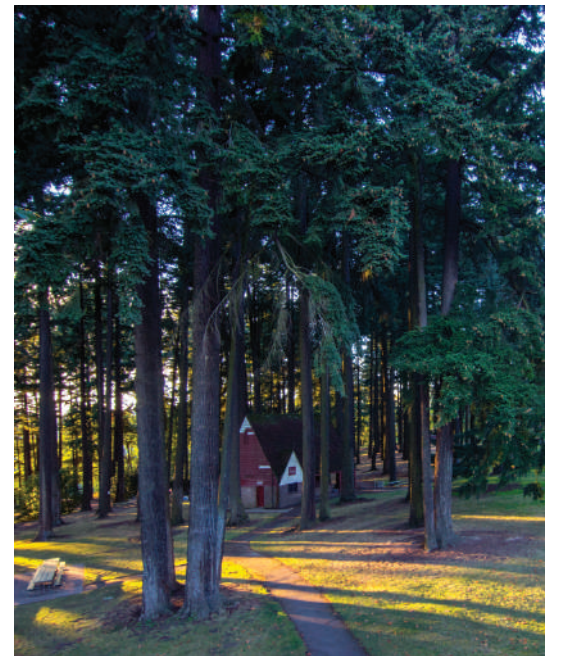

Gina Eiben
 Gina Eiben
 Chair

Jeff Anderson
 Jeff Anderson
 Executive Director

Board of Directors

Organizations listed for identification only.

Gina Eiben, Chair
 Perkins Coie, LLP

Zari Santer, Officer
 Portland Parks & Recreation, retired

Richard George
 Portland General Electric

Ex Officio
Mike Abbaté
 Portland Parks & Recreation

Julie Vigeland, Vice-Chair
 Community Volunteer

Jules Bailey
 Oregon Beverage Recycling Cooperative

Mary Ruble
 U.S. Bank

Jim Owens
 Portland Parks Board;
 Cogan Owens Greene

Alex Occhipinti, Treasurer
 Northrup Corporation

Charlie Baker
 NIKE, Inc.

Jack Jewsbury*
 Portland Timbers

David Thompson, Secretary
 Portland Business Alliance

Jim Francesconi
 Moda Health

Pamela Weatherspoon*
 Legacy Health

*Effective May 2017

CAMPAIGNS

Footbridge Over Burnside

The Footbridge Over Burnside Campaign finished 2016 with almost \$2 million secured toward the \$2.5 million goal. With energetic leadership from Charlie Swindells and the steering committee, the Parks Foundation launched design and construction of the Footbridge, which is slated for completion in 2018.

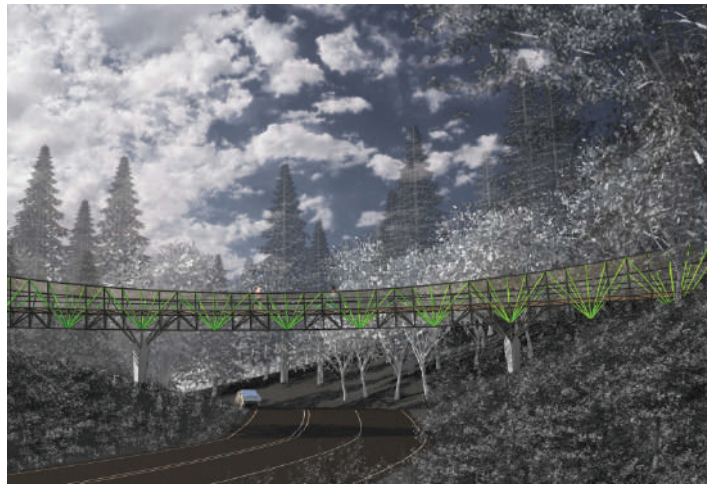

Thomas Cully Park

PPF established the Cully Park Campaign steering committee in collaboration with Verde, the nonprofit leading development of this new community-designed 25-acre park in an historically under-resourced Northeast Portland neighborhood. PPF's goal is to help raise the final \$500,000 in private gifts needed for the first phase of development. Cully Park is scheduled to open in 2017.



PARTNERSHIP



Summer Free For All (SFFA)

PPF helped to sponsor PP&R's popular Summer Free For All programs in 2016 at more than 95 parks, attracting 270,000 participants to concerts, movies and recreational activities.

Parke Diem

Despite a major windstorm on the day of the event that delayed many projects, more than 450 volunteers completed 34 projects from mid-October through the end of the year. Thanks to the determined Parke Diem volunteers and the PP&R staff who accomplished so much in adverse conditions!

"Through its **support** of various Friends groups, **fundraising** for projects like Cully Park and events like Parke Diem, the Portland Parks Foundation acts as a **catalyst** for investments by Portland citizens in a **unique and treasured resource**—our public parks and gardens." —Pat Frobes, Portland Parks Board and Friends of Peninsula Park Rose Garden

FOLLOW US:



Facebook
[portlandparksfoundation](http://portlandparksfoundation.org)



Instagram
[pdxparksfoundation](http://pdxparksfoundation.org)

Sign up for our Monthly Newsletter
Portlandpf.org/get-involved

SUPPORT

Nancy Hebb Freeman Trust

An exceptionally generous bequest of more than \$300,000 from Nancy Hebb Freeman created the foundation for a new grants program at PPF supporting volunteer-led parks groups all over Portland. The program will be inaugurated in 2017.

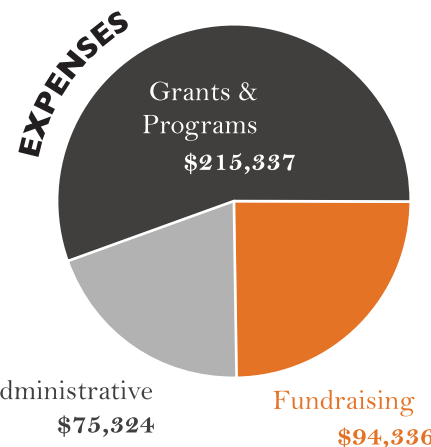
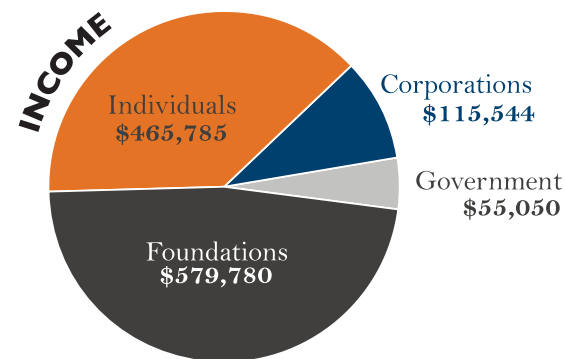

"At PP & R, we really depend on **partnerships** with lots of groups, but out of all those groups the **paramount organization is the Portland Parks Foundation.**" —Mike Abbaté, Portland Parks & Recreation Director

Special thanks to our partner Portland Parks & Recreation for its generous financial support in 2016.

Become a Parks

CHAMPION

Your gift helps to keep Portland parks among the best in the world.

"Portland parks play a **vital role** in enhancing the **quality of life** in our community; creating an identity for our neighborhoods, ensuring the **health of families and youth**, and contributing to the environmental well-being of our region."

—Von Summers, Senior Manager, Community Affairs, NW Natural

In 2016 the Portland Parks Foundation created the **Charles Jordan Circle** honoring Charles Jordan (pictured), a public parks visionary. The CJC comprises donors who share Charles's vision for excellent parks and support the Foundation's work with a **gift of \$1,000** or more annually.



Memberships start at \$60 and ensure that you are up to date on the latest parks news and Foundation events.